

WCM Plus Software Update v.5.5

How to update: To determine if an update is available for your Wireless Connect Module, connect the WCM Plus to the internet using the following steps:

- Connect your iOS, Android, Laptop, or PC to the WCM Hotspot:
 - **WCMPLUS-xxx** – the last three digits are unique to each WCM Plus
- Enter **192.168.4.1** in the address bar to open the WCM portal in a web browser.
- Connect the WCM-Plus device to the internet either by connecting an Ethernet connection or by connecting to a local Wi-Fi network.
 - An Ethernet connection usually increases download speeds.
 - To connect to a local Wi-Fi network, go to Network Settings / Wi-Fi Connection in the WCM-Plus portal and enter the network SSID and password.

Update your WCM-Plus using the following steps:

- Verify date/time settings are correct. Update if necessary. [MainMenu / Device / Date/Time](#)
- A notification will appear in the main menu indicating that an update is available.
 - This may take a short while as it checks the update server.
- Select **Software Version** to check the current version of software and, if an update is available, the latest version will also be shown.
- Tap **Update** to install the update. A notification will popup asking for confirmation of the upgrade process and a warning to allow several minutes for the update to complete. Once the process is complete a test page will print indicating the process is complete.

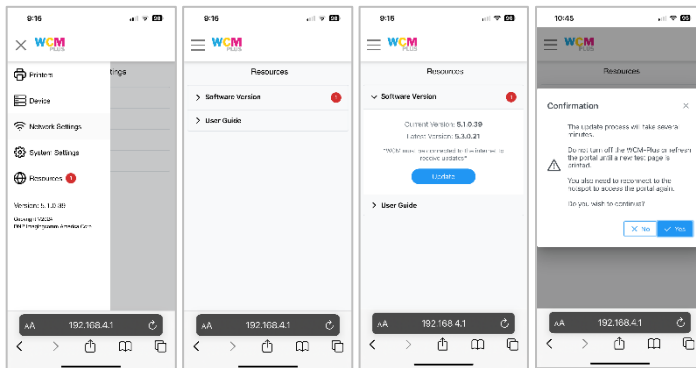

Note, Factory Reset will roll back to the version installed at the factory. The update process will install all the latest changes.

If you have any questions, please contact DNP Support or your DNP photo product reseller.

Release Notes:

This new release contains the following enhancements:

- Panorama Print Sizes
 - WCM-Plus now supports the following panorama print sizes
 - DS620/DS620A
 - 6x8 media
 - 6x14
 - 6x20
 - DS820/DS820A
 - 8x10 media
 - 8x18
 - 8x26
 - 8x12 media
 - 8x22
 - 8x32
 - API
 - An API has been created for developers to incorporate WCM-Plus feedback to their software. Contact DNP Tech Support for a copy.
 - Bug Fixes

Version	Date	Changes
5.1.0	Feb 24	Performance Improvements, Color Adjustment, Resources, Bug Fixes (border orientation, start up test print size)
5.3.0	Sep 24	Add Retail Feature, Add Channel Selection for Hotspot, Improved Party Print Slideshow, Added ez Share to Party Print
5.4		Skipped
5.5	Mar 25	Add Panorama print sizes, added API for WCM