

WCM Plus Software Update v.5.3

How to update: To determine if an update is available for your Wireless Connect Module, connect the WCM Plus to the internet using the following steps:

- Connect your iOS, Android, Laptop, or PC to the WCM Hotspot:
 - **WCMPLUS-xxx** – the last three digits are unique to each WCM Plus
- Enter **192.168.4.1** in the address bar to open the WCM portal in a web browser.
- Connect the WCM-Plus device to the internet either by connecting an Ethernet connection or by connecting to a local Wi-Fi network.
 - An Ethernet connection usually increases download speeds.
 - To connect to a local Wi-Fi network, go to Network Settings / Wi-Fi Connection in the WCM-Plus portal and enter the network SSID and password.

Update your WCM-Plus using the following steps:

- Verify date/time settings are correct. Update if necessary. [MainMenu / Device / Date/Time](#)
- A notification will appear in the main menu indicating that an update is available.
 - This may take a short while as it checks the update server.
- Select **Software Version** to check the current version of software and, if an update is available, the latest version will also be shown.
- Tap **Update** to install the update. A notification will popup asking for confirmation of the upgrade process and a warning to allow several minutes for the update to complete. Once the process is complete a test page will print indicating the process is complete.

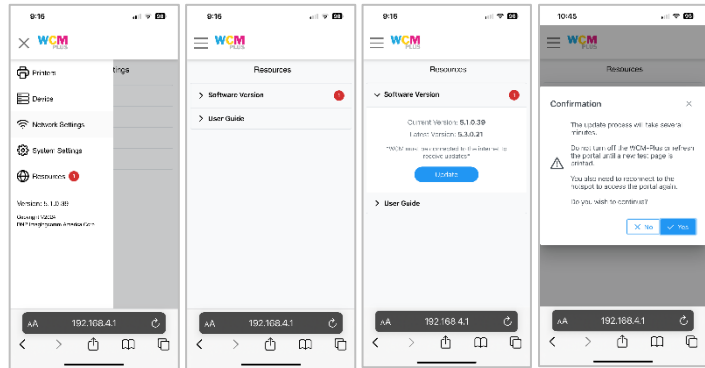

Note, Factory Reset will roll back to the version installed at the factory. The update process will install all the latest changes.

If you have any questions, please contact DNP Support or your DNP photo product reseller.

Release Notes:

This new release contains the following enhancements:

- Login & Print Services Menu
 - New menu item that consolidates Password Protection, WCM Print Feature, and WCM Retail Feature.
 - Provides a QR Code print or download option for event guest or retail customer access.
 - Retail Branding - Allows retailers to add their store logo to the customer facing screens
- New Feature- WCM Retail
 - Enables a new webapp for customer printing at retail
 - Allows retailers to upload their store logo for branding the customer facing webapp
 - WCM prints an “order” summary with each submission.
 - Allows retailers to hold print release until payment is made.
 - Allows easy setup of MyPhotoLab hotspot to work with marketing materials.
 - Provides the ability to turn the index print on or off
- Performance and Other Improvements
 - Add ability to change Hotspot Wi-Fi channels to optimize signal performance.
 - Allow images sent from ez Share Wi-Fi cards to be sent to Party Print
 - Improve slideshow output for Party Print
- Bug Fixes
 - Allow single quote / apostrophe use in SSID password
 - Fixed edit tool issues with very small images

Version	Date	Changes
5.0.0.42	Sept 23	Initial Release
5.0.0.57	Sept 23	Hot Folder Feature
5.0.0.75	Nov 23	Image queue: reprint; Image archive: incl. borders; ICC: load profiles, autodetect media type; Added FTP capability; Bug Fixes: update process, prints sent to correct printer
5.1.0	Feb 24	Performance Improvements, Color Adjustment, Resources, Bug Fixes (border orientation, start up test print size)
5.3.0	July 24	Add Retail Feature, Add Channel Selection for Hotspot, Improved Party Print Slideshow, Added ez Share to Party Print